

L2"x2"x1/4"
@ 3'-0" C/C (TYP.)
BRACINGS- WELD TO BLDG.
GIRTS- TYP. BOTH SIDES

NOTE: DOOR TOWER AND GUIDE
TO BE ADEQUATELY BRACED
TO BUILDING WALL CONSTRUCTION

- MOTOR OPERATOR- SIDE MOUNTED
TO TERMINAL BOX
- 1/2 H.P. MOTOR-480V-3Ø-60HZ
- SOLENOID DISC BRAKE
- HAND CHAIN & SHIFT DEVICE
- SAFETY CLUTCH
- V-BELT GUARD

100PSF BLAST LOAD

This drawing, including principle of design,
is the property of International Door, Inc.
It must not be reproduced in any manner nor
submitted to outside parties for examination
without our consent. It shall be used only
as a means of reference to work designed or
furnished by us, unless expressly authorized
and consented to in writing by International
Door, Incorporated, Canton, Michigan.

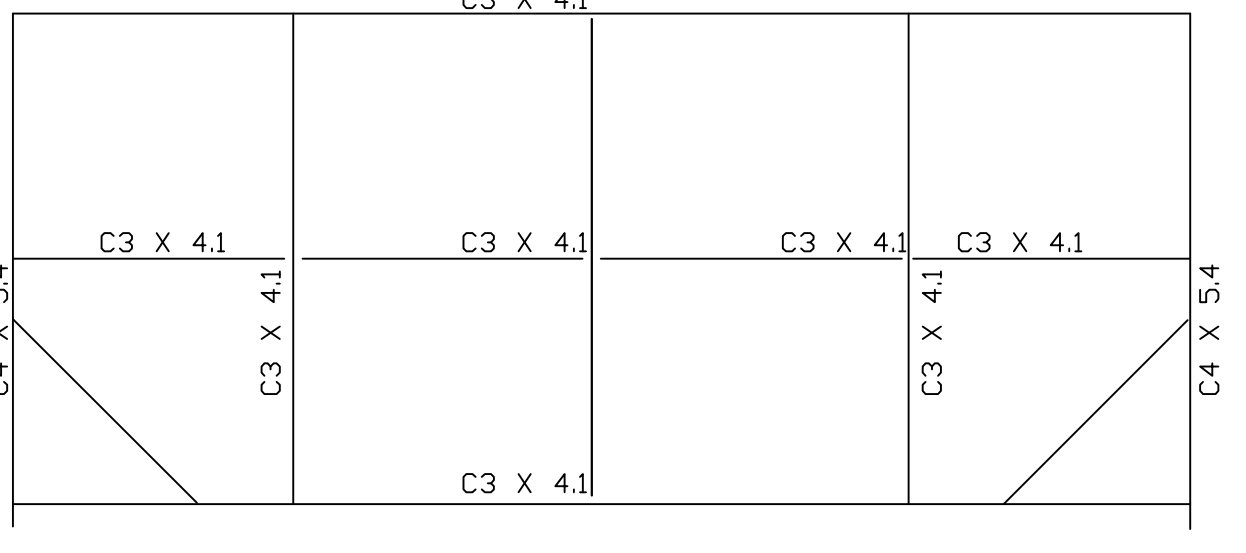

BOTTOM PANEL FRAMING- (SHOWN)
TOP & MIDDLE PANELS- (SIMILAR)

SHOP PAINT :
ONE COAT GRAY METALLIC PRIMER

REV	DATE	BY	DESCRIPTION
			TO FIELD
			TO SHOP
			SENT FOR APPROVAL-E-MAILED
INTERNATIONAL DOOR, INC. (734) 459-3000			
8001 Ronda Dr. Canton, Michigan 48187		PROJECT:	
VA OUTPATIENT CLINIC 6211 WATERFORD BLVD. EVANSVILLE, IN 47715			
BLAST RESISTANT DOOR -100PSF			

DRAWING TITLE: GENERAL ARRANGEMENT FOR THREE LEAF VERTICAL LIFT FIRE DOOR - DOUBLE SKIN - INSULATED WITH SIDE MTD. ELECTRIC OPERATOR			
DOOR NUMBER: _____		OPENING SIZE: 9'-11 1/4" X 7'-11 1/2"	
ARCH.			
CONTR.		DATE	
DRAWN: SAT		JOB NO.	
CHECKED: RB		CUSTOMER NO.	
APPROVED: DS		SHEET OF	

MINIMUM CLEARANCE REQUIRED
TO TOP OF DOOR EQUIPMENT
12'-1"
12'-0"

INTERIOR ELEVATION
THREE LEAF VERTICAL LIFT DOOR

(1) REQ'D. AS (SHOWN) DOOR NUMBER: 1117¹

2 X 1" X 1/8"
1/8" STR. W/1/4" S.T.S @ 9" C/C

BRONZE CONTACT SPRING
(WIRED TO TERMINAL BOX)

1/8" 1 PLY. C.I. RUBBER
STAINLESS STL. STRIP

DO NOT SCALE DRAWING